

# Free Spinning Inserts

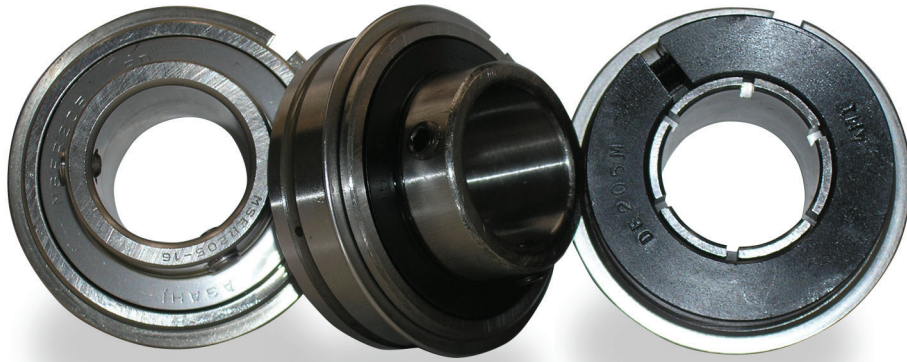

## Features

- Set Screw (SER) or Accu-Loc (SUE)
- Bore Sizes: 1/2" ~ 2-7/16" or (20mm ~ 40mm)
- Low Drag/Non Contact Seal
- Oil Lubrication (FS)
- Grease Lubrication (FSAM1)
- AISI 52100 Steel or 440C Stainless Steel
- Zone Hardened Wide Inner Ring
- Reinforced, Stabilized Nylon Retainer ("FSX")
- Stamped Steel Riveted Retainer ("FS")

## Free Spinning Seal

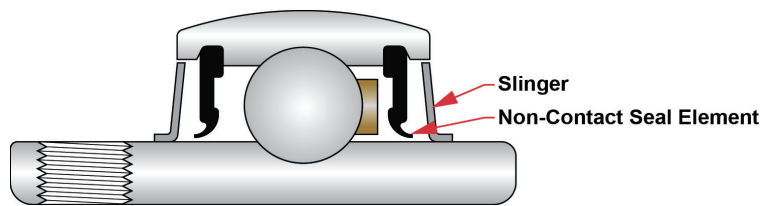

## Applications

- Packaging
- Printing Machinery
- In Line Systems
- Conveyor Equipment

## Options

- Low viscosity grease or oil lubrication
- We can make most bearing units free-spinning

\* NSF H-1 Rated low viscosity Food grade grease or oil lubrication available upon request.

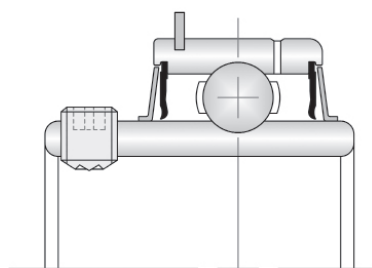

SER205-16FS

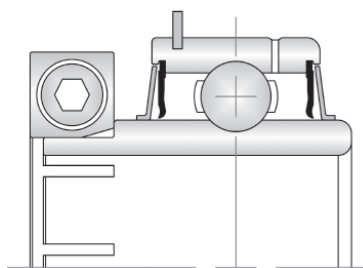

SUE205-16FS

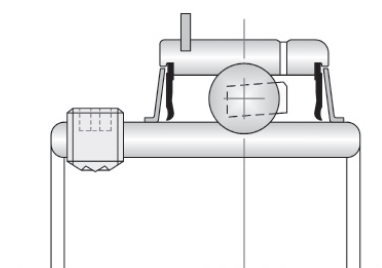

SER205-16FSX

STARTING TORQUE CHART (gf·cm)			
SER/SUE "FS"	Avg	Max	Min
201-204	30	45	25
205	40	60	30
206	60	90	45
207	80	120	60
208	100	150	75
209	120	180	90
210	140	200	105
211	160	210	120
212	180	230	135

INTERCHANGE BY MANUFACTURER			
BORE	AMI Part #	MB	SealMaster
1 (in.)	SUE205-16FS	ER16K-SFF	ER-16T XLO
25mm	SUE205FSAM1	ER205K MHFF	ER205T LO
1 (in.)	SER205-16FS	-	ER-16 XLO
	SER205-16FSX	ER16 HFF	-
25mm	SER205FS	-	ER205 XLO
	SER205FSX	ER205 HFF	-